

CT60 CT60 XP ULTRA-RUGGED MOBILE COMPUTER

Configuration Guide



CT60



CT60 NI
NON-INCENDIVE
ATEX / IEC EX



CT60 XP

THE
FUTURE
IS
WHAT
WE
MAKE IT

Honeywell

TABLE OF CONTENTS

2	CT60 FEATURE OVERVIEW N6603 STANDARD RANGE N6703 STANDARD RANGE N6703 HIGH DEFINITION (HD) NON-INCENDIVE / ATEX / IECEX - N6603 STANDARD RANGE	16	CT60 / CT60 XP VEHICLE DOCKS OPTION 1 – CT50 AND CT60 OPTION 2 – CT50, CT60 AND CT60 XP
6	CT60 XP FEATURE OVERVIEW N6703 STANDARD RANGE N6803 FLEXRANGE™ NEAR/ FAR RANGE N6703 HIGH DEFINITION (HD) DISINFECTANT READY HOUSING - N6703 STANDARD RANGE DISINFECTANT READY HOUSING - N6803 FLEXRANGE™ NEAR/ FAR RANGE	17	CT60 / CT60 XP VEHICLE INSTALL OPTION 1 – PORTABLE/ SUB CONTRACTOR INSTALL OPTION 2 – PORTABLE/ SUB CONTRACTOR INSTALL OPTION 3 - FIXED VEHICLE INSTALL WITH DIRECT CONNECTION TO VEHICLE BATTERY OPTION 4 - FIXED VEHICLE INSTALL WITH DIRECT CONNECTION TO VEHICLE BATTERY/ FUSE BLOCK OPTION 5 - FIXED VEHICLE INSTALL WITH THOR DC/DC CONVERTER
9	CT60 / CT60 XP CONFIGURATION MAP ANDROID	21	CT60 CHARGING AND COMMUNICATION OPTION 1 - CT50/CT60/CT60 XP QUAD CHARGER OPTION 2 - QUAD BATTERY CHARGER SPARE BATTERY OPTIONS OPTION 3 - DX2 FLEXDOCK 2-BAY OPTION 4 - DX4 FLEXDOCK 4-BAY
10	HONEYWELL EDGE SERVICES GOLD REPAIR SERVICES - 3 YEAR PLATINUM REPAIR SERVICES - 3 YEAR GOLD REPAIR SERVICES - 5 YEAR PLATINUM REPAIR SERVICES - 5 YEAR CT60 / CT60 XP - REPAIR SERVICES COVERAGE	24	IH21 RFID READER FOR CT60
13	CT60 / CT60 XP SOFTWARE DEVICE CLIENT PACK	25	CT60 DEX ADAPTER
14	CT60 / CT60 XP SCANNING OPTION 1 – CT60 SCAN HANDLE OPTION 2 – CT60 XP SCAN HANDLE	26	MISCELLANEOUS OPTIONAL PARTS MICRO-SD CARDS AC CORDS
15	CT60 / CT60 XP DESKTOP COMMUNICATIONS OPTION 1 – PORTABLE OPTION 2 – FIXED		

CT60 FEATURE OVERVIEW

N6603 Standard Range

Gorilla Glass 3

Display

4G LTE / GPS

WiFi / BT

N6603 6th GEN

Scanner

Included in the box:

- CT60 Mobile Computer
- Battery (318-055-012)
- Hand strap
- Tethered Stylus



N6603 Standard Range



CT60 Android - 4G WWAN - 4GB RAM/ 32GB Flash

CT60-L1N-BSC210A

CT60, Android GMS, WWAN, 802.11 a/b/g/n/ac/r/k/mc, 1D/2D Imager SR (N6603), 4GB/32GB Memory, 13MP Camera, BT 5.0, NFC, Battery Included

CT60 Android - 4G WWAN - 3GB RAM/ 32GB Flash

CT60-L1N-ASC210A

CT60, Android GMS, WWAN, 802.11 a/b/g/n/ac/r/k/mc, 1D/2D Imager SR (N6603), 3GB/32GB Memory, 13MP Camera, BT 5.0, NFC, Battery Included

CT60 Android- WiFi Only - 4GB RAM/ 32GB Flash

CT60-LON-BSC210A

CT60, Android GMS, WLAN, 802.11 a/b/g/n/ac/r/k/mc, 1D/2D Imager SR (N6603), 4GB/32GB Memory, 13MP Camera, BT 5.0, NFC, Battery Included

CT60 Android- WiFi Only - 3GB RAM/ 32GB Flash

CT60-LON-ASC210A

CT60, Android GMS, WLAN, 802.11 a/b/g/n/ac/r/k/mc, 1D/2D Imager SR (N6603), 3GB/32GB Memory, 13MP Camera, BT 5.0, NFC, Battery Included

Honeywell Repair Services

SVCCT60-SG3N

CT60 / CT60 XP, Edge Service, Gold Maintenance Contract, 3 Year, New Contract

ADD SVCREPLACE-MOB3

AddOn, Edge Service, Device Replacement, Mobility, 3 Year



CT60 FEATURE OVERVIEW

N6703 Standard Range



Warm Battery Swap



Gorilla Glass 5



4G LTE / GPS



WiFi / BT



N6703 7th GEN

Included in the box:

- CT60 Mobile Computer
- Battery (318-055-012)
- Hand strap
- Tethered Stylus

N6703 Standard Range



CT60 Android - 4G WWAN - 4GB RAM/ 32GB Flash

CT60-L1N-BRC210A

CT60, Android GMS, WWAN, 802.11 a/b/g/n/ac/r/k/mc, 1D/2D Imager SR (N6703), 4GB/32GB Memory, 13MP Camera, BT 5.0,NFC, Battery Included, warm swap

CT60 Android - 4G WWAN - 3GB RAM/ 32GB Flash

CT60-L1N-ARC210A

CT60, Android GMS , WWAN, 802.11 a/b/g/n/ac/r/k/mc, 1D/2D Imager SR (N6703), 3GB/32GB Memory, 13MP Camera, BT 5.0, NFC, Battery Included, warm swap

CT60 Android- WiFi Only - 4GB RAM/ 32GB Flash

CT60-LON-BRC210A

CT60, Android GMS, WLAN, 802.11 a/b/g/n/ac/r/k/mc, 1D/2D Imager SR (N6703), 4GB/32GB Memory, 13MP Camera, BT 5.0, NFC, Battery Included, warm swap

CT60 Android- WiFi Only - 3GB RAM/ 32GB Flash

CT60-LON-ARC210A

CT60, Android GMS, WLAN, 802.11 a/b/g/n/ac/r/k/mc, 1D/2D Imager SR (N6703), 3GB/32GB Memory, 13MP Camera, BT 5.0, NFC, Battery Included, warm swap

Honeywell Repair Services

SVCCT60-SG3N

CT60 / CT60 XP, Edge Service, Gold Maintenance Contract, 3 Year, New Contract

ADD SVCREPLACE-MOB3

AddOn, Edge Service, Device Replacement, Mobility, 3 Year



CT60 FEATURE OVERVIEW

N6703 High Definition (HD)



Warm Battery Swap



Gorilla Glass 5



4G LTE / GPS



WiFi / BT



N6703 HD Scanner

Included in the box:

- CT60 Mobile Computer
- Battery (318-055-012)
- Hand strap
- Tethered Stylus

N6703 High Definition



CT60 Android - 4G WWAN - 4GB RAM/ 32GB Flash

CT60-L1N-BDC210E

CT60, Android GMS, WWAN, 802.11 a/b/g/n/ac/r/k/mc, 1D/2D Imager (N6703 HD), 4GB/32GB Memory, 13MP Camera, BT 5.0, NFC, Battery Included, warm swap

CT60 Android- WiFi Only - 4GB RAM/ 32GB Flash

CT60-L0N-BDC210E

CT60, Android GMS, WLAN, 802.11 a/b/g/n/ac/r/k/mc, 1D/2D Imager (N6703 HD), 4GB/32GB Memory, 13MP Camera, BT 5.0, NFC, Battery Included, warm swap

Honeywell Repair Services

SVCCT60-SG3N

CT60 / CT60 XP, Edge Service, Gold Maintenance Contract, 3 Year, New Contract

ADD SVCREPLACE-MOB3

AddOn, Edge Service, Device Replacement, Mobility, 3 Year



CT60 FEATURE OVERVIEW

Non-Incendive / ATEX / IECex - N6603 Standard Range

NI

Hazardous

Gorilla Glass 3

Display

4G LTE / GPS

WiFi / BT

N6603 6th GEN

Scanner

- Included in the box:
- CT60 Mobile Computer
 - NI/ ATEX / IEC Ex Battery (318-055-013)
 - Hand strap
 - Tethered Stylus

N6603 Standard Range



CT60 Android - 4G WWAN - 4GB RAM/ 32GB Flash

CT60-L1N-BSC211A

CT60, Android GMS, WWAN, 802.11 a/b/g/n/ac/r/k/mc, 1D/2D Imager SR (N6603), Non-Incendive / ATEX/ IECex Certified, 4GB/32GB Memory, 13MP Camera, BT 5.0, NFC, Battery Included

CT60 Android- WiFi Only - 4GB RAM/ 32GB Flash

CT60-LON-BSC211A

CT60, Android GMS, WLAN, 802.11 a/b/g/n/ac/r/k/mc, 1D/2D Imager SR (N6603), Non-Incendive / ATEX/ IECex Certified, 4GB/32GB Memory, 13MP Camera, BT 5.0, NFC, Battery Included

Honeywell Repair Services

SVCCT60-SG3N

CT60 / CT60 XP, Edge Service, Gold Maintenance Contract, 3 Year, New Contract

ADD SVCREPLACE-MOB3

AddOn, Edge Service, Device Replacement, Mobility, 3 Year



CT60 XP FEATURE OVERVIEW

N6703 Standard Range

N6803 FlexRange™ Near/ Far Range

Included in the box:

- CT60 XP Mobile Computer
- Battery (318-055-018)
- Hand strap
- Tethered Stylus



N6703 Standard Range

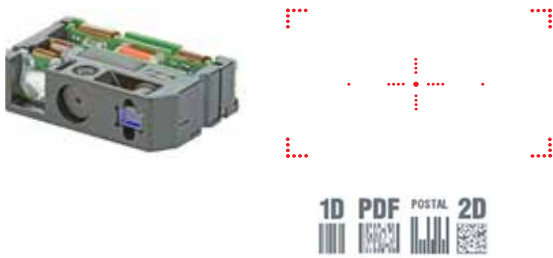

Warm Battery Swap



Gorilla Glass 5

Display



4G LTE / GPS



WiFi / BT



N6703
N6803
FlexRange

Scanner



N6803 FlexRange™



CT60 Android - 4G WWAN - 4GB RAM/ 32GB Flash

CT60-L1N-BRP210E

CT60 XP, Android GMS, WWAN, 802.11 a/b/g/n/ac/r/k/mc, 1D/2D Imager SR (N6703), 4GB/32GB Memory, 13MP Camera, BT 5.0,NFC, Battery Included, warm swap

CT60 Android- WiFi Only - 4GB RAM/ 32GB Flash

CT60-L0N-BRP210E

CT60 XP, Android GMS , WLAN, 802.11 a/b/g/n/ac/r/k/mc, 1D/2D Imager SR (N6703), 4GB/32GB Memory, 13MP Camera, BT 5.0, NFC, Battery Included, warm swap

CT60 Android - 4G WWAN - 4GB RAM/ 32GB Flash

CT60-L1N-BFP210E

CT60 XP, Android GMS, WWAN, 802.11 a/b/g/n/ac/r/k/mc, N6803 FlexRange, 4GB/32GB Memory, 13MP Camera, BT 5.0, NFC, Battery Included, warm swap

CT60 Android- WiFi Only - 4GB RAM/ 32GB Flash

CT60-L0N-BFP210E

CT60 XP, Android GMS, WLAN, 802.11 a/b/g/n/ac/r/k/mc, N6803 FlexRange, 4GB/32GB Memory, 13MP Camera, BT 5.0, NFC, Battery Included, warm swap

Honeywell Repair Services

SVCCT60-SG3N

CT60 / CT60 XP, Edge Service, Gold Maintenance Contract, 3 Year, New Contract

ADD SVCREPLACE-MOB3

AddOn, Edge Service, Device Replacement, Mobility, 3 Year

CT60 XP FEATURE OVERVIEW

N6703 High Definition (HD)

Warm Battery Swap

Gorilla Glass 5

4G LTE / GPS

WiFi / BT

N6703 HD Scanner

Included in the box:

- CT60 XP Mobile Computer
- Battery (318-055-018)
- Hand strap
- Tethered Stylus



N6703 High Definition

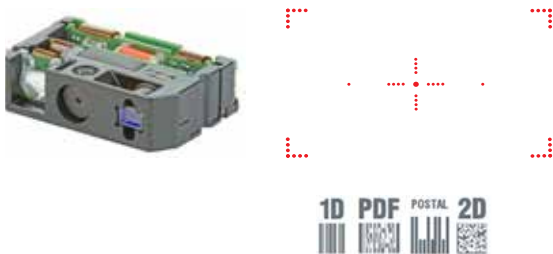

CT60 Android - 4G WWAN - 4GB RAM/ 32GB Flash

CT60-L1N-BDP210E

CT60 XP, Android GMS, WWAN, 802.11 a/b/g/n/ac/r/k/mc, 1D/2D Imager (N6703 HD), 4GB/32GB Memory, 13MP Camera, BT 5.0,NFC, Battery Included, warm swap

CT60 Android- WiFi Only - 4GB RAM/ 32GB Flash

CT60-L0N-BDP210E

CT60 XP, Android GMS , WLAN, 802.11 a/b/g/n/ac/r/k/mc, 1D/2D Imager (N6703 HD), 4GB/32GB Memory, 13MP Camera, BT 5.0, NFC, Battery Included, warm swap

Honeywell Repair Services

SVCCT60-SG3N

CT60 / CT60 XP, Edge Service, Gold Maintenance Contract, 3 Year, New Contract

ADD SVCREPLACE-MOB3

AddOn, Edge Service, Device Replacement, Mobility, 3 Year

CT60 XP FEATURE OVERVIEW

Disinfectant Ready Housing - N6703 Standard Range

Disinfectant Ready Housing - N6803 FlexRange™ Near/ Far Range



Disinfectant Ready



Warm Battery Swap



Gorilla Glass 5



4G LTE / GPS



WiFi / BT



N6703
N6803
FlexRange
Scanner

Included in the box:

- CT60 XP Mobile Computer
- Battery (318-055-019)
- Hand strap
- Tethered Stylus



CT60 Android - 4G WWAN - 4GB RAM/ 32GB Flash

CT60-L1N-BRP21DE	CT60 XP Disinfectant Ready, Android GMS, WWAN, 802.11 a/b/g/n/ac/r/k/mc, 1D/2D Imager SR (N6703), 4GB/32GB Memory, 13MP Camera, BT 5.0,NFC, Battery Included, warm swap
-------------------------	---

CT60 Android- WiFi Only - 4GB RAM/ 32GB Flash

CT60-L0N-BRP21DE	CT60 XP Disinfectant Ready, Android GMS , WLAN, 802.11 a/b/g/n/ac/r/k/mc, 1D/2D Imager SR (N6703), 4GB/32GB Memory, 13MP Camera, BT 5.0, NFC, Battery Included, warm swap
-------------------------	---

CT60 Android - 4G WWAN - 4GB RAM/ 32GB Flash

CT60-L1N-BFP21DE	CT60 XP Disinfectant Ready, Android GMS, WWAN, 802.11 a/b/g/n/ac/r/k/mc, N6803 FlexRange, 4GB/32GB Memory, 13MP Camera, BT 5.0, NFC, Battery Included, warm swap
-------------------------	--

CT60 Android- WiFi Only - 4GB RAM/ 32GB Flash

CT60-L0N-BFP21DE	CT60 XP Disinfectant Ready, Android GMS, WLAN, 802.11 a/b/g/n/ac/r/k/mc, N6803 FlexRange, 4GB/32GB Memory, 13MP Camera, BT 5.0, NFC, Battery Included, warm swap
-------------------------	--





Honeywell Repair Services

SVCCT60-SG3N	CT60 / CT60 XP, Edge Service, Gold Maintenance Contract, 3 Year, New Contract
ADD SVCREPLACE-MOB3	AddOn, Edge Service, Device Replacement, Mobility, 3 Year



CT60 / CT60 XP CONFIGURATION MAP

Android

											DESCRIPTION	NOTES
BLUETOOTH/ WIFI												
WWAN												
NFC												
MEMORY												
IMAGER												
CAMERA												
OPERATING SYSTEM												
BATTERY												
OPTIONS												
DOMAIN												
CT60-												
L											802.11 a/b/g/n/ac + Bluetooth 5.0	2x2 MIMO IEEE 802.11 a/b/g/n/ac/r/k/mc ; Wi-Fi certified V5.0 Bluetooth and BLE Supported Bluetooth Profiles: HFP,PBAP, A2DP, AVRCP, OPP, SPP, GATT
	0										No WWAN	
	1										LTE (4G) GPS, UMTS/HSPA+ (3G) GSM/GPRS/EDGE	WWAN RADIO (ATT/VZW/SPRINT/TMO/NA/EU) LTE (FDD) – BANDS 1,2,3,4,5,7 .8,12,13,17,19,20,25,26,28,29 / LTE (TDD) – BANDS 38,39,40,41 UMTS/HSPA+ (3G) – BANDS 1, 2, 4, 5, 6, 8, 9, 19 / GSM/GPRS/EDGE QUAD-BAND (850/900/1800/1900 MHZ)
		N									Near Field Communications (NFC)	
			--									
				A							3GB RAM, 32GB Flash Memory	2.2 GHz Qualcomm Snapdragon™ 660 octa-core
				B							4GB RAM, 32GB Flash Memory	2.2 GHz Qualcomm Snapdragon™ 660 octa-core
					D						1D/2D Imager (N6703HD) – High Definition	
					F						1D/2D Imager (N6803FR) – FlexRange™	
					R						1D/2D Imager (N6703SR) – Standard Range	
					S						1D/2D Imager (N6603SR) – Standard Range	
						C					Camera	13MP Rear Camera
						P					XP	
							1				Android (Non-GMS)	
							2				Android (GMS)	Google Mobile Services (GMS) certified – Play Store
								1			Standard Battery	
									0		No Option	
									1		Non-Incendive (NI) Certified / ATEX / IECEx	
										D	Disinfectant Ready Housing	Disinfectant Ready Housings (DRHs). DRHs utilize plastics designed to withstand the harshness of frequent cleaning with disinfectants without compromising the lifespan of the equipment.
										A	ANZ & Argentina	Argentina, Australia, New Zealand
										E	WorldWide	Argentina, Australia, Austria, Belgium, Brazil, Bulgaria, Columbia, Croatia, Cyprus, Czech Republic, Denmark, Dominican Republic, Egypt, Estonia, Finland, France, Germany, Greece, Honduras, Hong Kong, Iceland, India, Indonesia, Ireland, Italy, Japan, Jordan, Kuwait, Latvia, Liechtenstein, Lithuania, Luxembourg, Malaysia, Malta, Morocco, Netherlands, New Zealand, Norway, Oman, Poland, Portugal, Qatar, Romania, Russia, Saudi Arabia, Singapore, Slovakia, Slovenia, South Africa, South Korea, Spain, Sri Lanka, Sweden, Switzerland, Thailand, UAE, Ukraine, United Kingdom, Vietnam



HONEYWELL EDGE SERVICES

CT60 / CT60 XP – Repair Services

Honeywell Edge Services give you the confidence of having leading-class technologies combined with service and support plans that are designed to keep you operational for longer.

Gold Repair Services – 3 Year

The most flexible contract in the industry. The Edge Services Gold Support contract allows you to select the right coverage for your organization, and includes 5-Day Depot Repairs and:

Service Overview

- Repair or replacement of damaged components, wear and tear, and accidental damage.
- Flexibility to add any Add-On Service

PART NUMBER	DESCRIPTION
SVCCT60-SG3N	CT60 / CT60 XP, Edge Service, GOLD Maintenance Contract, 5 Day Turnaround, 3 Year , New Contract

Add-On Accessory Replacement Service

Provides replacement chargers, docks, charging cables, or scan handles should they be damaged or stop working.

ADD	SVCACC-MOB3	AddOn, Edge Service, Accessory Service , Mobility, 3 Year . Service covers docks, charger cradles, scan handles
------------	-------------	--

Add-On Battery Replacement Service

Provides replacement batteries every 18 months after purchase.

ADD	SVCBATTERY-MOB3	AddOn, Edge Service, Battery Service, Mobility, 3 Year , 1 Replacement Battery over life of contract
------------	-----------------	---

Add-On Device Replacement Service

Replacement devices should a device be damaged beyond repair.

ADD	SVCREPLACE-MOB3	AddOn, Edge Service, Device Replacement, Mobility, 3 Year
------------	-----------------	--

Add-On Image Management Service

Ensures that when a device returns from being repaired, it has all the proper applications loaded back on the device.

ADD	SVCIMAGEMGMT-MOB3	AddOn, Edge Service, Image Service, Mobility, 3 Year
------------	-------------------	---

Add-On Spare Management Service

Manages every aspect of your spare pool.

ADD	SVCSPAREMGMT-MOB3	AddOn, Edge Service, Advanced Exchange, Mobility, 3 Year . Customer owned spare pool, Minimum Purchase required, contact your local Honeywell Service Representative for more information.
------------	-------------------	---

Add-On Sentinel Extended Service

Security patches and minor enhancements to legacy Android operating systems, typically added after year 3.

ADD	SVSENTINEL-MOB1	Sentinel Service, 1 Year Android Support Contract
ADD	SVSENTINEL-MOB2	Sentinel Service, 2 Year Android Support Contract

Platinum Repair Services – 3 Year

The Edge Services Platinum Support contract is the only total support contract in the industry today offering 2-Day Depot Repairs or Spare Pool Management with 3-year contract, that includes:

Service Overview

- Repair or replacement of damaged components
- SVCREPLACE-MOB3 - Replacement devices should a device be damaged beyond repair
- SVCACC-MOB3 - Accessory replacement service
- SVCBATTERY-MOB3 - Battery replacement service
- PPSW-OPINTEL-PMP36 - Operational Intelligence Performance Professional licenses
- SVCSPAREMGMT-MOB3 - Spare pool management (optional, minimum quantity required)
- Telephone-based technical support
- Sentinel Extended Service that protects customers for future security updates on Android.

PART NUMBER	DESCRIPTION
SVCCT60-SP3N	CT60 / CT60 XP, Edge Service, PLATINUM, 2 Day Turnaround, 3 Year, New Contract
OPERATIONAL INTELLIGENCE SETUP MUST BE ORDERED WITH PLATINUM EDGE SERVICE CONTRACT	
PPPS-OIPLI-SETUP	OpIntel Free Platinum Installation Basic & Professional



HONEYWELL EDGE SERVICES

CT60 / CT60 XP – Repair Services

Honeywell Edge Services give you the confidence of having leading-class technologies combined with service and support plans that are designed to keep you operational for longer.

Gold Repair Services – 5 Year

The most flexible contract in the industry. The Edge Services Gold Support contract allows you to select the right coverage for your organization, and includes 5-Day Depot Repairs and:

Service Overview

- Repair or replacement of damaged components, wear and tear, and accidental damage.
- Flexibility to add any Add-On Service

PART NUMBER	DESCRIPTION
SVCCT60-SG5N	CT60 / CT60 XP, Edge Service, GOLD Maintenance Contract, 5 Day Turnaround, 5 Year , New Contract

Add-On Accessory Replacement Service

Provides replacement chargers, docks, charging cables, or scan handles should they be damaged or stop working.

ADD	SVCACC-MOB5	AddOn, Edge Service, Accessory Service , Mobility, 5 Year . Service covers docks, charger cradles, scan handles
------------	-------------	--

Add-On Battery Replacement Service

Provides replacement batteries every 18 months after purchase.

ADD	SVCBATTERY-MOB5	AddOn, Edge Service, Battery Service, Mobility, 5 Year , 2 Replacement Battery over life of contract
------------	-----------------	---

Add-On Device Replacement Service

Replacement devices should a device be damaged beyond repair.

ADD	SVCREPLACE-MOB5	AddOn, Edge Service, Device Replacement, Mobility, 5 Year
------------	-----------------	--

Add-On Image Management Service

Ensures that when a device returns from being repaired, it has all the proper applications loaded back on the device.

ADD	SVCIMAGEMGMT-MOB5	AddOn, Edge Service, Image Service, Mobility, 5 Year
------------	-------------------	---

Add-On Spare Management Service

Manages every aspect of your spare pool.

ADD	SVCSPAREMGMT-MOB5	AddOn, Edge Service, Advanced Exchange, Mobility, 5 Year . Customer owned spare pool, Minimum Purchase required, contact your local Honeywell Service Representative for more information.
------------	-------------------	---

Add-On Sentinel Extended Service

Security patches and minor enhancements to legacy Android operating systems, typically added after year 3.

ADD	SVSENTINEL-MOB1	Sentinel Service, 1 Year Android Support Contract
ADD	SVSENTINEL-MOB2	Sentinel Service, 2 Year Android Support Contract

Platinum Repair Services – 5 Year

The Edge Services Platinum Support contract is the only total support contract in the industry today offering 2-Day Depot Repairs or Spare Pool Management with 5-year contract, that includes:

Service Overview

- Repair or replacement of damaged components
- SVCREPLACE-MOB5 - Replacement devices should a device be damaged beyond repair
- SVCACC-MOB5 - Accessory replacement service
- SVCBATTERY-MOB5 - Battery replacement service
- PPSW-OPINTEL-PMP60 - Operational Intelligence Performance Professional licenses
- SVCSPAREMGMT-MOB5 - Spare pool management (optional, minimum quantity required)
- Telephone-based technical support
- Sentinel Extended Service that protects customers for future security updates on Android. The 5 year Sentinel coverage provides extended Android updates in years 4 and 5.

PART NUMBER	DESCRIPTION
SVCCT60-SP5N	CT60 / CT60 XP, Edge Service, PLATINUM, 2 Day Turnaround, 5 Year, New Contract
OPERATIONAL INTELLIGENCE SETUP MUST BE ORDERED WITH PLATINUM EDGE SERVICE CONTRACT	
PPPS-OIPLI-SETUP	OpIntel Free Platinum Installation Basic & Professional



HONEYWELL REPAIR SERVICES

CT60 / CT60 XP – Repair Services Coverage

For Best-In-Class Service

CT60 / CT60 XP



Warranty Cover Against Product Defect

BASIC Service

Gold Coverage:

- Accidental Damage
- Wear & Tear

Includes Replacement of:

- Handstrap
- Screen Protector
- Stylus



Flexible GOLD Add-Ons ordered separately

- SVCACC-MOB3 Accessories
- SVCBATTERY-MOB3 Batteries
- SVCREPLACE-MOB3 Device Replacement
- SVCIMAGEMGMT-MOB3 Image Service
- SVCSPAREMGMT-MOB3 Advanced Exchange

GOLD Service

Platinum Coverage

- Battery Replacement
- Coverage for Docks/ Chargers
- Sentinel Extended Service for Android Security Updates

- Accidental Damage
- Device Replacement
- Wear & Tear



PLATINUM Service

PART NUMBER	DESCRIPTION
SVCCT60-EXW2	CT60 / CT60 XP, BASIC, 10-15 Day Turnaround, 2 Years (1 Year Factory Warranty + 1 Year Extended)
SVCCT60-SG3N	CT60 / CT60 XP, Edge Service, GOLD Maintenance Contract, 5 Day Turnaround, 3 Year, New Contract
ADD SVCACC-MOB3	AddOn, Edge Service, Accessory Service , Mobility, 3 Year. Service covers docks, charger cradles, scan handles and car adapter
ADD SVCBATTERY-MOB3	AddOn, Edge Service, Battery Service, Mobility, 3 Year, 1 Replacement Battery over life of contract
ADD SVCREPLACE-MOB3	AddOn, Edge Service, Device Replacement, Mobility, 3 Year
ADD SVCIMAGEMGMT-MOB3	AddOn, Edge Service, Image Service, Mobility, 3 Year
ADD SVCSPAREMGMT-MOB3	AddOn, Edge Service, Advanced Exchange, Mobility, 3 Year. Customer owned spare pool, Minimum Purchase required.
SVCCT60-SP3N	CT60 / CT60 XP, Edge Service, PLATINUM, 2 Day Turnaround, 3 Year, New Contract

CT60 / CT60 XP SOFTWARE

Device Client Pack

Device Client Pack (DCP) includes first year maintenance. Add additional years of software maintenance for the applications below.

Device Client Pack

Order Separately



Launcher



BasicTE



Enterprise Browser



SmartTE Terminal Emulator



Launcher - gives the customer total control over which apps can be run on the device.



BasicTE Android device Terminal Emulation is a simplified alternative for those not yet ready to upgrade to SmartTE.



Enterprise Browser provides corporations the ability to run standard web applications from a controlled environment.



Terminal Emulator – Full featured SmartTE allows legacy green screen apps to be transformed to the look and feel of native apps. These clients are single session Honeywell TE Licensing. They can also utilize traditional single or multi-session StayLinked Licenses.

PART NUMBER	DESCRIPTION
DCP-001	Device Client Pack License (Launcher, BasicTE & Enterprise Browser)
DCP-SFT1	Device Client Pack - 1 Year Maintenance (Launcher, BasicTE & Enterprise Browser)
DCP-SFT3	Device Client Pack - 3 Year Maintenance (Launcher, BasicTE & Enterprise Browser)
DCP-SFT5	Device Client Pack - 5 Year Maintenance (Launcher, BasicTE & Enterprise Browser)

PART NUMBER	DESCRIPTION
SMARTTE-001	SMARTTE - SINGLE PATH W-1 Year Maintenance
SMARTTE-SFT3	SMARTTE – 3 Year Software Maintenance
SMARTTE-SFT5	SMARTTE – 5 Year Software Maintenance

CT60 / CT60 XP SCANNING

Option 1 – CT60 Scan Handle

Use for Scan intensive applications.
Easy on and Easy off to allow for recharging in CT60 desktop docks.
Compatible Devices: CT50, CT60
(Not Compatible with CT60 XP)
Not Compatible with Single Dock, Quad Charger or Vehicle Dock.



	PART NUMBER	DESCRIPTION
1	CT50-SCH	User installable scan handle for scan intensive applications.

Option 2 – CT60 XP Scan Handle

Use for Scan intensive applications.
Compatible Devices: CT60 XP
(Not Compatible with CT50 / CT60)
Compatible with Single Dock, Quad Charger. Not Compatible with Vehicle Dock.
Supports CT60 XP stylus stored inside scan handle.



	PART NUMBER	DESCRIPTION
1	CT60-XP-SCH-DR	CT60XP Scan Handle Disinfectant Ready (Stylus not included)

CT60 / CT60 XP DESKTOP COMMUNICATIONS

Option 1 – Portable

USB Communication to PC/ Mac OR Snap-On Charging



PART NUMBER	DESCRIPTION
1	CT50-USB
2	213-029-001

Option 2 – Fixed

USB and optional Ethernet Communication & Single Battery Charger.



PART NUMBER	DESCRIPTION
1	CT50-HB-0
OR	CT50-EB-0
2	321-576-004
3	**

CT60 / CT60 XP VEHICLE DOCKS

Option 1 – CT50 and CT60

Not Compatible with CT60 XP.



PART NUMBER	DESCRIPTION
CT50-MB-0	Vehicle Dock w/ hard wired 3-pin power cable and a standard USB Type A cable Supports CT50 and CT60 (NOT Compatible with CT60 XP)
CT50-MB-1	Vehicle Dock w/ hard wired 3-pin power cable and a standard USB Type A cable, includes cigarette lighter power adapter Supports CT50 and CT60 (NOT Compatible with CT60 XP)

Option 2 – CT50, CT60 and CT60 XP

Vehicle Dock includes adapter inserts for CT50 / CT60 and CT60 XP.



PART NUMBER	DESCRIPTION
CT50-MB-0-XP	Vehicle Dock w/ hard wired 3-pin power cable and a standard USB Type A cable Supports CT50, CT60 and CT60 XP.
CT50-MB-1-XP	Vehicle Dock w/ hard wired 3-pin power cable and a standard USB Type A cable, includes cigarette lighter power adapter Supports CT50, CT60 and CT60 XP.

CT60 / CT60 XP VEHICLE INSTALL

Option 1 – Portable/ Sub Contractor Install

Simple Vehicle Charging, portable between vehicles.
Compatible with CT50, CT60 and CT60 XP.



	PART NUMBER	DESCRIPTION
1	CT50-MC	Snap-on cup with Cigarette Lighter plug.

Option 2 – Portable/ Sub Contractor Install

Windscreen Suction Cup Mount, portable between vehicles.



Recommended Screws
8#-32-UNC
(Length = 0.5 inch)
50143775-001 Pack 4 Screws

	PART NUMBER	DESCRIPTION
1	CT50-MB-1	Vehicle Dock w/ hard wired 3-pin power cable and a standard USB Type A cable Supports CT50 and CT60 (NOT Compatible with CT60 XP)
OR	CT50-MB-1-XP	Vehicle Dock w/ hard wired 3-pin power cable and a standard USB Type A cable Supports CT50, CT60 and CT60 XP.
2	RAM-B-166-202U	Suction Cup Mount Kit

CT60 / CT60 XP VEHICLE INSTALL

Option 3 – Fixed Vehicle Install with Direct Connection to Vehicle Battery

Best used when the vehicle input voltage varies, 10– 30V.



	PART NUMBER	DESCRIPTION
1	CT50-MB-0	Vehicle Dock w/ hard wired 3-pin power cable and a standard USB Type A cable. Supports CT50 and CT60 (NOT Compatible with CT60 XP)
OR	CT50-MB-0-XP	Vehicle Dock w/ hard wired 3-pin power cable and a standard USB Type A cableSupports CT50, CT60 and CT60 XP.
2	203-802-001	Vehicle Dock Installation Kit (Power Option: For connection of Vehicle Dock directly to vehicle battery. Includes power cables and cable mounting hardware)
3	805-611-001	Mounting Kit, V-Dock RoHS

CT60 / CT60 XP VEHICLE INSTALL

Option 4 - Fixed Vehicle Install with Direct Connection to Vehicle Battery/ Fuse Block

Best used when the vehicle input voltage varies, 10- 30V.



	PART NUMBER	DESCRIPTION
1	CT50-MB-0	Vehicle Dock w/ hard wired 3-pin power cable and a standard USB Type A cable. Supports CT50 and CT60 (NOT Compatible with CT60 XP)
OR	CT50-MB-0-XP	Vehicle Dock w/ hard wired 3-pin power cable and a standard USB Type A cableSupports CT50, CT60 and CT60 XP.
2	226-109-003	72" (182.88 cm) Fuse block Power Cable with spade lugs and 3-pin connector
OR	226-109-004	22" (55.8 cm) Fuse block Power Cable with spade lugs and 3-pin connector
3	805-611-001	Mounting Kit, V-Dock RoHS
OPTIONAL	203-803-001	Vehicle Dock Fuse Block Power Kit RoHS (Provides connection to vehicle fuse block). Requires Power Cable (226-109-003 or 226-109-004).

CT60 / CT60 XP VEHICLE INSTALL

Option 5 – Fixed Vehicle Install with Thor DC/DC Converter

Best used when the vehicle input voltage varies, 9-60V or 50-150V.



	PART NUMBER	DESCRIPTION
1	CT50-MB-0	Vehicle Dock w/ hard wired 3-pin power cable and a standard USB Type A cable. Supports CT50 and CT60 (NOT Compatible with CT60 XP)
OR	CT50-MB-0-XP	Vehicle Dock w/ hard wired 3-pin power cable and a standard USB Type A cableSupports CT50, CT60 and CT60 XP.
2	9000311PWRSPPLY	DC/DC Converter Kit, 9-60V DC, RoHS (Requires 226-109-003 Wiring Harness)
OR	9000313PWRSPPLY	DC/DC Converter Kit, 50-150V DC RoHS (Requires 226-109-003 Wiring Harness)
	226-109-003	72" (182.88 cm) Fuse block Power Cable with spade lugs and 3-pin connector
3	805-611-001	Mounting Kit, V-Dock RoHS

CT60 CHARGING AND COMMUNICATION

Option 1 – CT50/CT60/CT60 XP Quad Charger

Chargebase – Quad Dock Charge Only
Netbase – Quad Dock with Ethernet



	PART NUMBER	DESCRIPTION
1	CT50-CB-0	Chargebase - Kit includes Dock and Power Supply
OR	CT50-NB-0	Netbase - For Ethernet comms and recharging upto 4 computers
2	**	AC Power Cord – See Page 28 for Country Specific Power Cords

Option 2 – Quad Battery Charger

Charge up to 4 batteries simultaneously
Supports Batteries: 318-055-005 - Battery, Standard, CT50 / CT60 (4090mAh)
318-055-012 - Battery, Standard, CT50 / CT60 (4020mAh)
318-055-013 - Battery, Standard, CT60 NI / ATEX / IECex (4020mAh)
318-055-018 - Battery, Standard, CT60 XP (4020mAh)

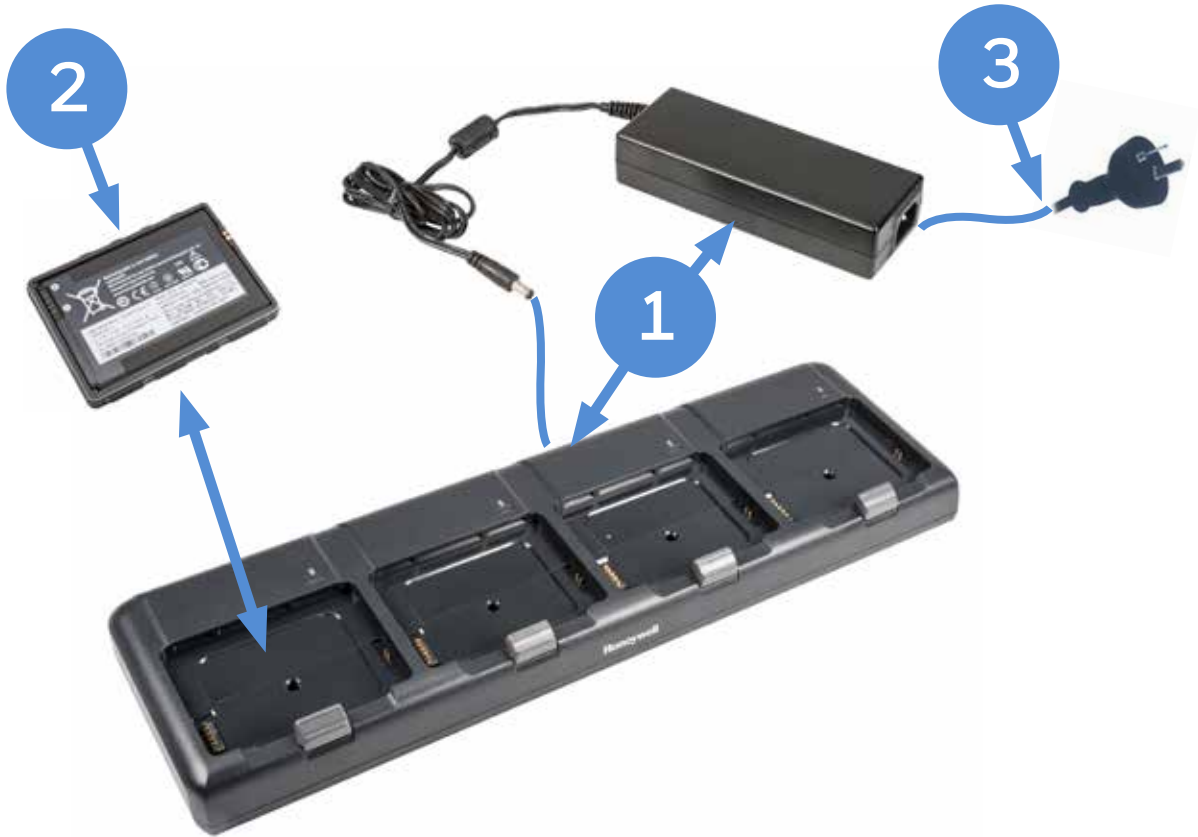

	PART NUMBER	DESCRIPTION
1	CT50-QBC-0	Quad Battery Charger - Kit includes Dock and Power Supply
2	**	See Page 19 for Battery selection
3	**	AC Power Cord – See Page 28 for Country Specific Power Cords

CT60 BATTERY

Spare Battery Options



CT60
CT60-LxN-xxxxx0x

CT60 NI / ATEX / IEC Ex
CT60-LxN-xxxxx1x

CT60 XP
CT60-LxN-xxPxxxx

CT60 XP Disinfectant Ready
CT60-LxN-xxPxxDx

	PART NUMBER	DESCRIPTION
1	318-055-012	BATTERY, STD, 4020mAh, CT50/60, MAXELL
2	318-055-013	BATTERY, STD, 4020mAh, MAXELL,CT60 NI / ATEX / IEC Ex
3	318-055-018	BATTERY, STD, 4020mAh, CT60 XP, MAXELL
4	318-055-020	BATTERY, STD, 4020mAh, CT60 XP Disinfectant Ready, MAXELL

CT60 CHARGING AND COMMUNICATION

Option 3 – DX2 FlexDock 2-Bay

Charge Only – Dual Dock Charge Only
Ethernet – Dual Dock with Ethernet



	PART NUMBER	DESCRIPTION
1	852-918-002	FlexDock Base Dual Charge Only
OR	852-919-002	FlexDock Base Dual Ethernet
2	50135809-001-K	FLEXDOCK CUP CT50/CT60 (Order 2 per DX2 FlexDock)
3	851-095-131	Universal Supply, 12V 48W Right Angle 2.5x5.5 Level IV
4	**	AC Power Cord – See Page 28 for Country Specific Power Cords

Option 4 – DX4 FlexDock 4-Bay

Charge Only – Quad Dock Charge Only
Ethernet – Quad Dock with Ethernet



	PART NUMBER	DESCRIPTION
1	852-916-002	FlexDock Base Quad Charge Only
OR	852-917-002	FlexDock Base Quad Ethernet
2	50135809-001-K	FLEXDOCK CUP CT50/CT60 (Order 4 per DX4 FlexDock)
3	851-064-427	Universal Power Supply, 12V 8A 4Skt Level VI RoHS
4	**	AC Power Cord – See Page 28 for Country Specific Power Cords

CT60 RFID

IH21 RFID Reader for CT60

Connect the IH21 to the CT60 via Bluetooth.
Not Compatible with CT60 XP.



IH21 Charging Cradle

	PART NUMBER	REGION	DESCRIPTION
1	IH21A0020	AUS	IH21 Bluetooth RFID Reader with e-Pop-Loq, UHF Antenna, Trigger Handle, Battery, Battery Cover, no imager, red and black. AU
OR	IH21A0014	FCC	IH21 Bluetooth RFID Reader with e-Pop-Loq, UHF Antenna, Trigger Handle, Battery, Battery Cover, no imager, red and black.FCC
OR	IH21A0002	ETSI	IH21 Bluetooth RFID Reader with e-Pop-Loq, UHF Antenna, Trigger Handle, Battery, Battery Cover, no imager, red and black.ETSI
2	IH21-EPL-CT50		Cover,ePop-Loq CT50/CT60, IH21 (Not Compatible with CT60 XP)
3	IH21-CB-1		IH21 Docking Cradle with World traveler PSU and Mini USB Lead, red and black
OPTIONAL	IH21-QBC-1		4-Slot Battery Charger. Order power supply 851-812-001 & Power Cord separately
OPTIONAL	851-812-001		AC ADAPTER,12V/60W,2.5X5.5MM,LEVEL VI. Order AC Power Cord – See Page 28 for Country Specific Power Cords
OPTIONAL	318-060-001		Spare Battery for IH21 RFID reader

CT60 DEX ADAPTER

DEX adapter for DSD route management

Connect the DEX-BLE-10 to the CT60/ CT60 XP via Bluetooth.



	PART NUMBER	DESCRIPTION
1	DEX-BLE-10	DEX Bluetooth Adapter with charger, cable, (USB-WALL-CHARGER-U) and battery (DEX-10-BATTERY)
OPTIONAL	DEX-10-BATTERY	Replacement Battery for DEX-BLE-10 ,3.7V LI-ION 750mAh
OPTIONAL	USB-WALL-CHARGER-U	USB wall charger, US plug, Micro USB, USB A, 5V 2A, DEX-BLE-10
OPTIONAL	454-036-001	License, DEX Store Front (License, DEX Store Front) (Desktop license. DEX Store Front emulates a retailer `s host system for testing of DEX/UCS transactions between a PC running DEX Store Front and a mobile computer)
OPTIONAL	454-038-001	License, DEX Mobile (License, DEX Mobile) (Runtime client license. Enables runtime operation of the MobileDEX application or applications developed using the DEX Toolkit. Order 1 License per mobile computer.)

MISCELLANEOUS

Optional Parts



PART NUMBER	DESCRIPTION
213-049-001	CT50 HAND STRAP, pack of 3



PART NUMBER	DESCRIPTION
213-049-003	HAND STRAP, ADJUSTABLE, CT50, PACK OF 3



PART NUMBER	DESCRIPTION
50121666-001	Power Adapter,12V 3A, No Power Cord, Compatible with CT50/CT60 Homebase / eHomebase / Quad Battery Charger



PART NUMBER	DESCRIPTION
213-048-001	Pack of five CT50 replacement styluses.



PART NUMBER	DESCRIPTION
346-087-001	SCREEN PROTECTOR, CT50/CT60/CT60 XP



PART NUMBER	DESCRIPTION
50121667-001	Power Adapter,12V 7A, No Power Cord, CT50/CT60 Quad Chargebase/Quad Netbase

MISCELLANEOUS

Optional Parts



PART NUMBER	DESCRIPTION
CT50-CC-12	CHARGING CABINET FOR CT60 and CT50 with space to house 12 Computers and 12 Spare Batteries. Quad battery chargers (CT50-QBC-0) and Quad ChargeBase (CT50-CB-0) or NetBase (CT50-NB-0) must be ordered separately.



PART NUMBER	DESCRIPTION
825-239-001	HOLSTER,SCAN HANDLE,CT50, CT60 and CT60 XP



PART NUMBER	DESCRIPTION
825-237-001	POUCH, CT50/CT60/CT60 XP



PART NUMBER	DESCRIPTION
825-238-001	CT50/CT60/CT60 XP Holster

MISCELLANEOUS

Micro-SD Cards

Honeywell Recommended – ATP Industrial Grade Micro SD Cards

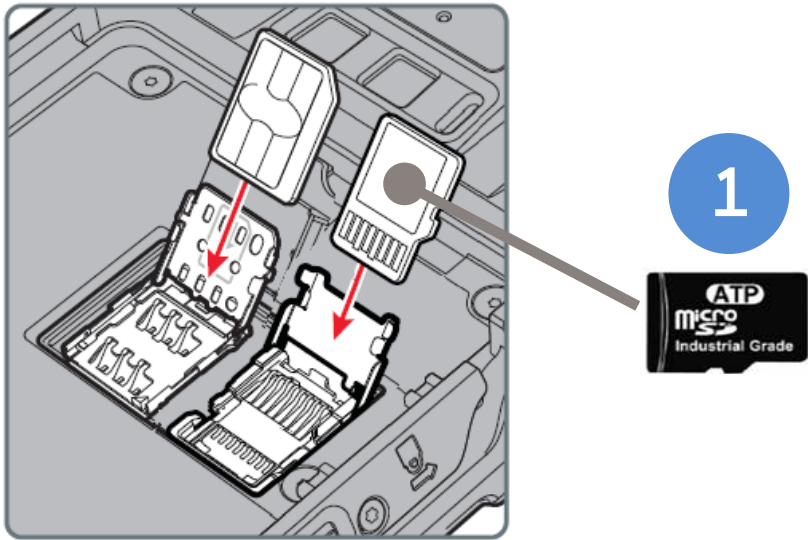

Why ATP Industrial Grade SD?

ATP's SIP (System-In-Packaging) manufacturing process encapsulates all exposed components and points of failure to ensure the products are fully waterproof, shockproof, and ESD (Electro-Static Discharge) proof. ATP Industrial Grade SD/SDHC Cards can withstand at least an operating/storage temperature range of at least -40 to 85 degrees Celsius. In addition to this temperature range, the cards are completely waterproof, dustproof, and ESD (Electro-Static Discharge) proof. All ATP Industrial Grade SD/SDHC cards are produced under a stringent RoHs and Green Package compliant manufacturing process to guarantee a consistent high level of build quality and performance. ATP Industrial SD cards deliver outstanding performance with read speed (seq) up to 18MB/sec and write speed (seq) up to 16MB/sec. All ATP Industrial Grade CF, SD, USB drives, and SSDs are constructed using best-in-class SLC(Single-Level Cell) components with enhanced Error Correction Code(ECC) functions and wear levelling algorithms. This results in MTBF ratings over 2 million hours and the highest write cycle lifetimes in the industry.

	PART NUMBER	DESCRIPTION
1	856-065-004	MICRO-SD CARD, 1GB , AFIGUDI, ROHS
OR	856-065-005	MICRO-SD CARD, 2GB , AFIGUDI, ROHS
OR	856-065-006	MICRO-SD CARD, 4GB , AFIGUDI, ROHS
OR	856-065-007	MICRO-SD CARD, 8GB , AFIGUDI, ROHS

AC Cords

Regional Power Cords



AC Power - C13 Type Connector

PART NUMBER	DESCRIPTION
50117501-001	POWER CORD AUSTRALIA 2500MM,SLED CB
321-501-002	AC Power Cord, Denmark RoHS
77900508E	Cable: power cord, power supply to AC outlet, straight, Power cord, Europe EU, IEC320-C13, 2.5 m (8.2 ft)
321-502-002	AC Power Cord, India/S Africa RoHS
321-500-002	AC Power Cord, Japan RoHS
9000093CABLE	AC POWER CABLE, C14 TYPE, SWITZERLAND 3-PIN
77900507E	Cable: power cord, power supply to AC outlet, straight - Power cord, UK, IEC320-C13, 2.5 m (8.2 ft)
1-974028-025	AC Power Cord, US RoHS

MISCELLANEOUS

Disclaimer

Honeywell International Inc. (“HII”) reserves the right to make changes in specification and other information contained in this document without prior notice, and the reader should in all cases consult HII to determine whether any such changes have been made. The information in this publication does not represent a commitment on the part of HII.

HII shall not be liable for technical or editorial errors or omissions contained herein; nor for incidental or consequential damages resulting the furnishing, performance, or use of this material.

This document contains proprietary information that is protected by copyright. All rights are reserved. No part of this document may be photocopied, reproduced, or translated into another language with-out prior written consent of HII.

Web Address: www.honeywellaidc.com

The Bluetooth trademarks are owned by Bluetooth SIG, Inc., U.S.A and licensed to Honeywell.

Thor and Mobility Edge are trademarks or registered trademarks of Honeywell International Inc. in the United States and/or other countries.

Android is a trademark or registered trademark of Google Inc. in the United States and/or other countries. Windows is a trademark or registered trademark of Microsoft Corporation.

Qualcomm and Snapdragon are trademarks or registered trademarks of Qualcomm Incorporated in the United States and/or other countries.

Other product names mentioned in the manual may be trademarks of registered trademarks of their respective companies and are the property of their respective owners.

All rights reserved.

For more information
www.honeywellaidc.com

Honeywell Safety and Productivity Solutions
9680 Old Bailes Road
Fort Mill, SC 29707
800-582-4263
www.honeywell.com